

Z O Y A
G H A Z A L A B A Y

Unit Types

Profound Simplicity

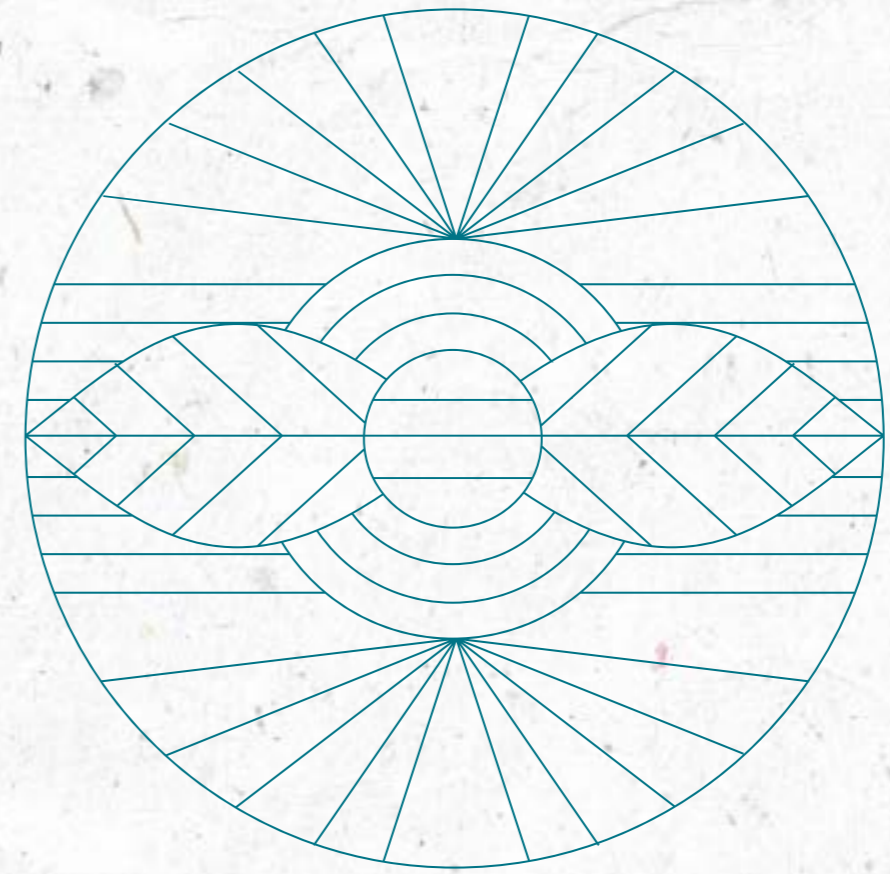

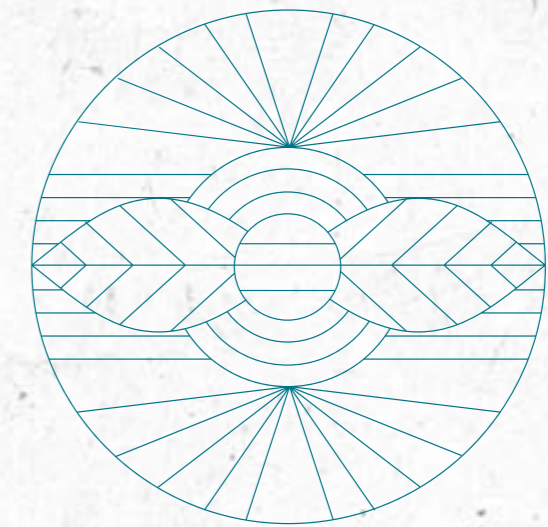

Villa Type A
5 Bedrooms



Porch	3.25m x 3.00m
Lobby	3.50m x 4.80m
Master Bedroom	4.25m x 4.80m
Master Dressing	1.60m x 3.00m
Master Bathroom	2.50m x 2.60m
Terrace	2.30m x 4.30m
Bedroom 1	3.60m x 4.00m
Bathroom 1	2.40m x 1.60m
Bedroom 2	3.60m x 4.50m
Bathroom 2	2.80m x 1.70m
Bedroom 3	3.70m x 4.00m
Bathroom 3	1.80m x 2.50m
Guest Bathroom	1.80m x 3.00m

Guest Bedroom	3.60m x 4.50m
Guest Toilet	1.10m x 2.45m
Terrace	3.05m x 5.90m
Terrace	4.50m x 3.65m
Dining Room	3.05m x 5.00m
Reception	4.00m x 7.25m
Laundry	2.40m x 1.80m
Kitchen	4.50m x 3.00m
Nanny's Room	2.90m x 2.70m
Nanny's Toilet	2.90m x 1.20m
Driver's Room	2.70m x 2.00m
Driver's Toilet	1.20m x 2.00m

Total Area 340sqm

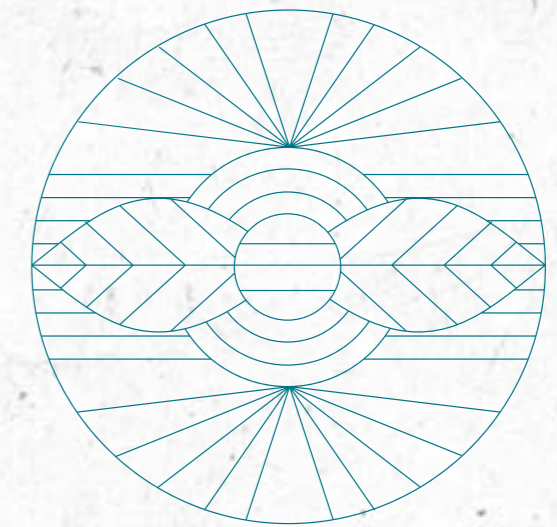

Villa Type B
6 Bedrooms



Ground Floor

Ground Floor

Lobby	5.60m x 2.30m
Reception	8.55m x 4.00m
Dining	4.40m x 4.45m
Kitchen	4.00m x 3.20m
Guest Bedroom	3.80m x 3.60m
Guest Toilet	2.80m x 1.30m
Guest Bathroom	2.50m x 1.60m
Patio	2.65m x 3.35m
Nanny's Room	2.65m x 2.70m
Nanny's Toilet	1.60m x 1.10m
Driver's Room	2.65m x 1.60m
Driver's Toilet	1.00m x 1.60m
Terrace	4.00m x 2.80m
Terrace	5.00m x 3.50m



First Floor

First Floor

Master Bedroom	3.70m x 4.20m
Master Dressing	2.50m x 2.00m
Master Bathroom	2.50m x 2.50m
Terrace	3.55m x 2.55m
Bedroom 1	3.80m x 3.70m
Bathroom 1	2.50m x 1.60m
Bedroom 2	3.80m x 3.60m
Bathroom 2	2.50m x 1.60m
Bedroom 3	3.60m x 3.90m
Bathroom	3.50m x 1.80m
Bedroom 4	4.75m x 3.75m

Total Area	375sqm
-------------------	---------------

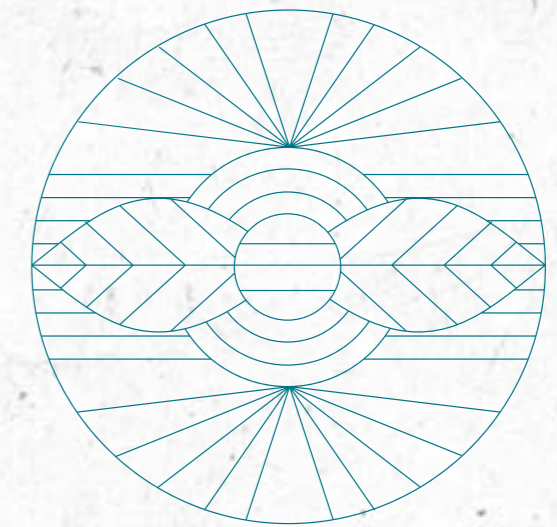

Senior Twin House
5 Bedrooms



Ground Floor

Ground Floor

Reception	4.15m x 3.90m
Living Room	3.80m x 3.50m
Dining Room	3.00m x 3.00m
Kitchen	3.10m x 2.90m
Nanny's Room	2.15m x 2.00m
Nanny's Toilet	1.80m x 1.20m
Driver's Room	2.65m x 1.50m
Driver's Toilet	1.50m x 1.20m
Guest Bedroom	4.10m x 3.70m
Guest Bathroom	2.90m x 1.60m
Terrace	3.80m x 3.00m
Terrace	4.10m x 3.00m



First Floor

First Floor

Master Bedroom	3.90m x 3.80m
Master Bathroom	2.50m x 1.60m
Terrace	3.75m x 3.80m
Bedroom 1	3.80m x 3.60m
Bathroom 1	1.80m x 1.80m
Terrace	1.80m x 1.70m
Bedroom 2	4.20m x 4.10m
Bathroom 2	2.90m x 1.45m
Terrace	4.25m x 2.80m
Bedroom 3	3.60m x 3.60m
Bathroom 3	2.35m x 1.60m

Total Area	307sqm
-------------------	---------------

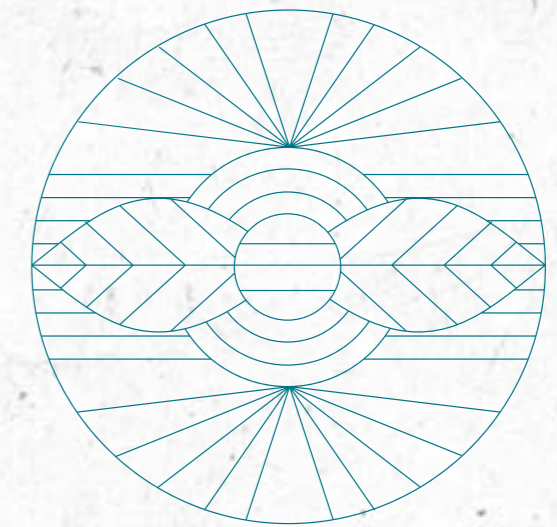

Junior Twin House
5 Bedrooms



Ground Floor

Ground Floor

Lobby	3.90m x 1.50m
Reception	3.65m x 4.30m
Dining	4.00m x 3.50m
Kitchen	3.60m x 2.70m
Guest Toilet	2.35m x 1.30m
Nanny's Room	2.35m x 2.20m
Nanny's Toilet	1.15m x 1.50m
Driver's Room	2.35m x 2.10m
Driver's Toilet	1.15m x 2.20m
Terrace	3.75m x 2.15m
Terrace	2.40m x 3.90m



First Floor

First Floor

Master Bedroom	3.90m x 3.80m
Master Dressing	2.75m x 1.80m
Master Bathroom	2.75m x 1.50m
Terrace	3.60m x 3.10m
Bedroom 1	3.60m x 3.60m
Bathroom 1	2.75m x 1.60m
Terrace	1.80m x 1.60m
Bedroom 2	3.60m x 3.75m
Bedroom 3	3.60m x 3.65m
Bathroom	1.50m x 2.30m
Total Area	238sqm

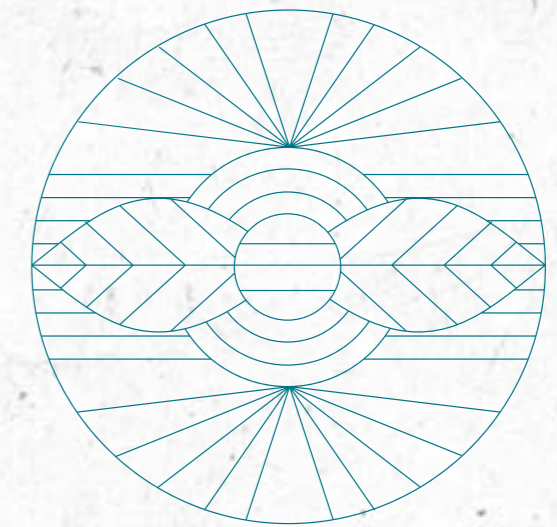

Chalet Type A
6 Types



Ground Floor Corner

Ground Floor Corner

Lobby	1.90m x 1.45m
Reception & Dining	7.75m x 6.00m
Master Bedroom	3.70m x 3.60m
Master Bathroom	3.15m x 1.35m
Master Dressing	1.70m x 1.70m
Bedroom 1	4.20m x 3.50m
Bedroom 2	3.80m x 3.80m
Bathroom	2.60m x 2.00m
Guest Toilet	1.25m x 2.00m
Kitchen	2.60m x 3.60m
Nanny's Room	1.60m x 2.60m
Nanny's Toilet	1.60m x 0.90m
Terrace	7.30m x 2.00m
Terrace	3.90m x 1.40m

Total Area	176sqm
------------	--------





Ground Floor Middle

Ground Floor Middle

Lobby	3.40m x 1.60m
Reception	7.00m x 4.90m
Kitchen	4.00m x 2.90m
Master Bedroom	4.00m x 3.50m
Master Bathroom	3.00m x 1.80m
Master Dressing	2.35m x 1.80m
Terrace	3.20m x 2.00m
Guest Toilet	3.30m x 1.40m
Bedroom 1	3.60m x 3.60m
Bathroom 1	2.40m x 1.60m
Bedroom 2	3.60m x 3.80m
Bathroom	3.30m x 1.45m
Nanny's Room	2.50m x 1.65m
Nanny's Toilet	0.90m x 1.65m
Terrace	4.75m x 1.70m
Total Area	185sqm





First Floor Corner

First Floor Corner

Terrace	53 m2
Reception & Dining	4.20m x 5.20m
Kitchen	2.60m x 2.70m
Bedroom 1	3.60m x 4.50m
Bedroom 2	3.70m x 4.55m
Bedroom 3	3.60m x 4.30m
Bathroom	1.60m x 2.80m
Bathroom 1	1.60m x 2.80m
Terrace	2.10m x 2.15m
Terrace	3.60m x 1.05m
Total Area	122sqm





First Floor Middle

First Floor Middle

Lobby	2.40m x 1.20m
Reception & Dining	7.00m x 4.90m
Kitchen	3.80m x 2.90m
Master Bedroom	4.00m x 3.50m
Master Bathroom	3.00m x 1.80m
Master Dressing	2.35m x 1.80m
Bedroom 1	3.60m x 3.60m
Bathroom 1	2.40m x 1.60m
Bedroom 2	3.60m x 3.60m
Bathroom 2	3.30m x 1.45m
Guest Toilet	3.30m x 1.40m
Nanny's Room	3.20m x 1.65m
Nanny's Toilet	0.90m x 1.65m
Terrace	4.75m x 1.70m

Total Area 205sqm





Second Floor Corner

Second Floor Corner

Terrace	85 m2
Reception & Dining	7.10m x 5.50m
Kitchen	3.95m x 2.90m
Master Bedroom	3.60m x 3.90m
Master Bathroom	2.40m x 1.60m
Bedroom 1	3.60m x 3.80m
Bedroom 2	3.60m x 3.60m
Bathroom	1.70m x 3.30m
Guest Toilet	2.35m x 1.35m
Nanny's Room	2.30m x 1.65m
Nanny's Toilet	0.90m x 1.65m

Total Area	167sqm
-------------------	---------------





Second Floor Middle

Second Floor Middle

Lobby	1.20m x 3.00m
Reception & Dining	4.10m x 5.55m
Kitchen	3.00m x 2.60m
Master Bedroom	3.60m x 3.60m
Master Bathroom	1.60m x 2.20m
Master Dressing	1.80m x 1.90m
Bedroom	3.60m x 4.60m
Bathroom	1.60m x 2.20m
Terrace	4.30m x 2.00m
Terrace	1.55m x 3.10m

Total Area	119sqm
-------------------	---------------



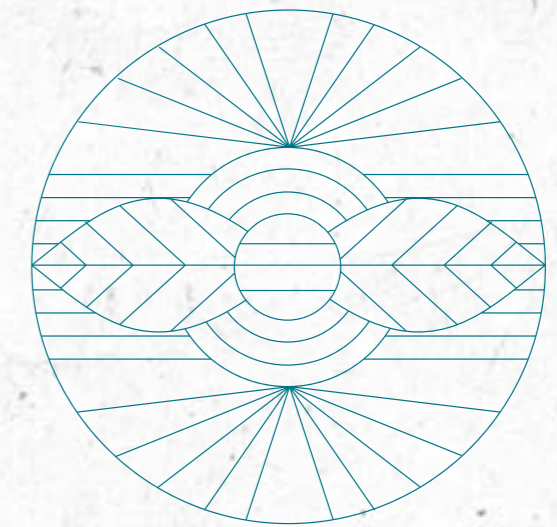

Chalet Type B
4 Types



Ground Floor Corner

Ground Floor Corner

Reception & Dining	4.00m x 7.05m
Kitchen	2.40m x 3.00m
Master Bedroom	3.60m x 3.60m
Master Bathroom	2.40m x 1.70m
Bedroom 1	3.60m x 3.60m
Bedroom 2	3.60m x 4.60m
Bathroom	3.60m x 1.70m
Terrace	3.90m x 7.05m

Total Area	137sqm
-------------------	---------------

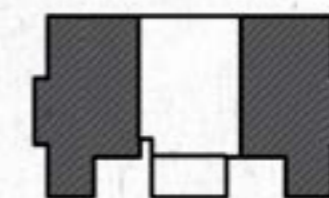



Ground Floor Middle

Ground Floor Middle

Reception & Dining	3.80m x 7.25m
Kitchen	2.40m x 2.50m
Master Bedroom	3.50m x 3.60m
Master Bathroom	3.70m x 2.70m
Bedroom	3.70m x 3.60m
Bathroom	3.65m x 1.50m
Terrace	5.20m x 1.60m
Terrace	3.70m x 2.30m

Total Area	124sqm
-------------------	---------------





First Floor

First Floor

Terrace	44.0m²
Reception & Dining	4.00m x 7.90m
Kitchen	2.50m x 2.50m
Master Bedroom	3.70m x 3.70m
Master Bathroom	3.10m x 1.60m
Bedroom 1	3.60m x 4.60m
Bathroom 1	1.60m x 2.80m
Bedroom 2	3.60m x 3.60m
Bathroom 2	2.60m x 1.60m

Total Area	133sqm
-------------------	---------------

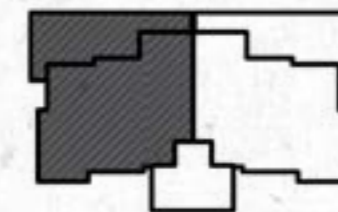



Second Floor

Second Floor

Terrace	37.65m²
Reception & Dining	4.00m x 7.90m
Kitchen	2.50m x 2.50m
Master Bedroom	3.70m x 4.00m
Master Bathroom	1.80m x 2.80m
Bedroom	3.60m x 3.60m
Bathroom	1.70m x 2.80m

Total Area	103sqm
-------------------	---------------

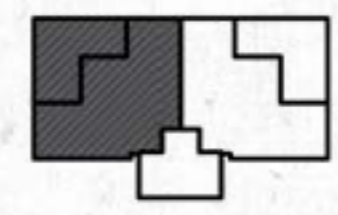

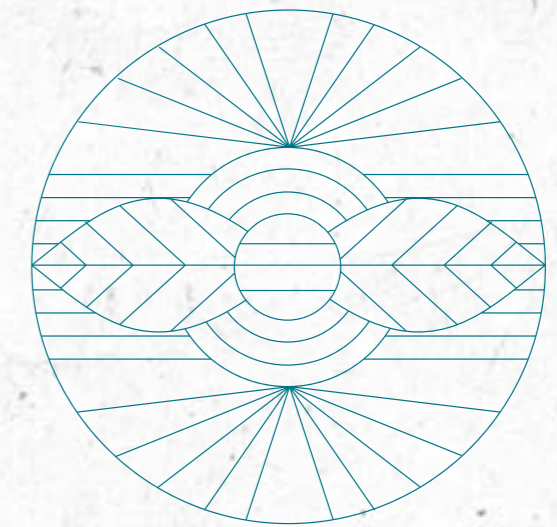

Gallery















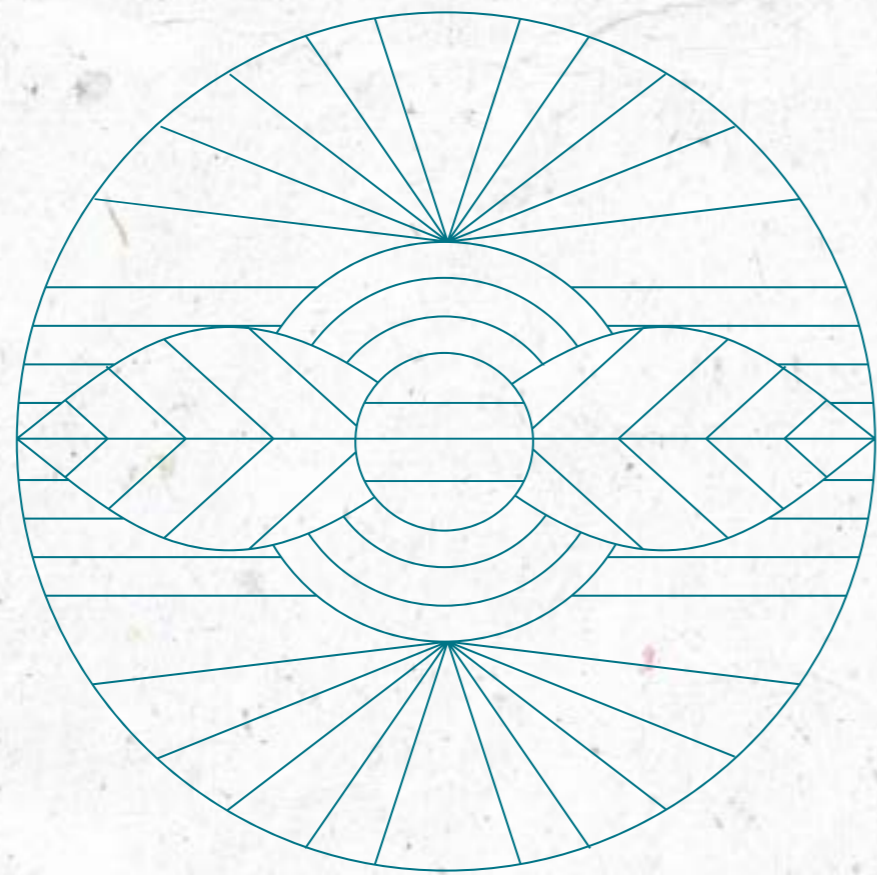

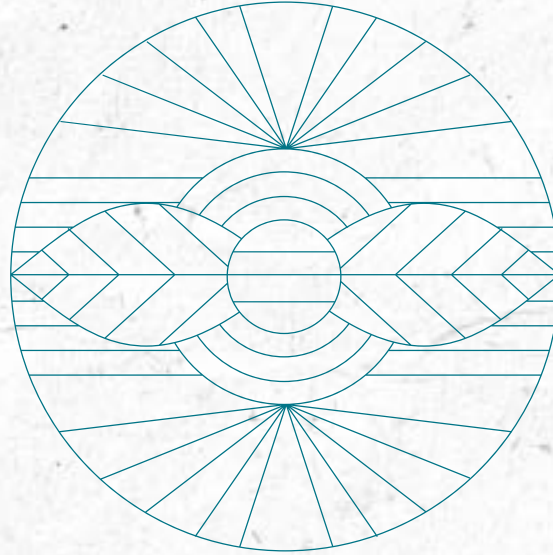

Z O Y A
G H A Z A L A B A Y

Profound Simplicity

**Landmark Sabbour Developments.
Cairo Office:
Building 289, Second Business Sector, New Cairo, P.O.Box:51234
Cairo, Egypt**

**North Coast Office:
Zoya , 142 Km Alex - Matrouh Road.**

**Call Center: 16295
www.landmark-sabbour.com**